

MAK FLOOR

How to apply it effortlessly

Mak Floor is a self-adhesive layer for floor applications featuring a uniquely rough and significantly tactile texture. Thanks to its 550 microns, it is indeed our thickest Floor Graphics film. For this reason, when applying Mak Floor, it is better to take the following precautions:

- 1 ENSURE THAT THE UNDERLYING SURFACE IS DRY AND COMPATIBLE WITH THE INSTALLATION OF ADHESIVE FILMS.** Also make sure that the material is acclimatized (this factor contributes to the proper functioning of the glue and to the elasticity of the material);
- 2 CLEAN THE UNDERLYING SURFACE THOROUGHLY BEFOREHAND,** with the help of compressed air if necessary. Factors such as dust, sand, debris, low-tension or silicone-based compounds can interfere with the action of the glue, both in the short and long term;
- 3 PRE-HEAT THE UNDERLYING SURFACE** using a hot air gun **AND THEN APPLY THE FILM WITH THE HELP OF A RUBBER ROLLER,** heating it in the same way. The hot air helps to make the material much more flexible and workable, while the action of the roller allows the film to better adapt to the roughness of the underlying surface (asphalt, concrete, etc.). The use of the hot air gun is recommended especially for outdoor applications and for car parks, including indoor ones.
- 4 LEAVE THE GLUE TO SET FOR AT LEAST 4 HOURS** before touching the film. Mak Floor glue needs time to reach and maintain the permanent staying power stage. Initial adhesion, while excellent, guarantees resistance to rubbing caused by people or small objects, but not to that of vehicles.

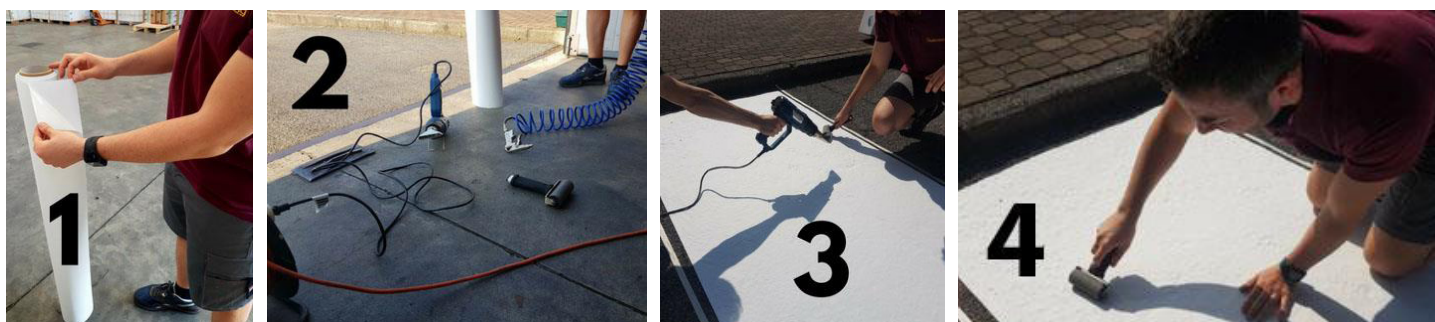

Was this guide helpful?

YOUR OPINION MATTERS! Email us at salescare@guandong.eu